



We have the right space for your event



Managed by Rembrandt Hotels Corporation Co., Ltd.

Parking Available

- ❖ Maximum Capacity: 250 cars
- ❖ VIP Reserved Spaces: 15 cars



Sukhumvit Soi 18



Centrally located in Bangkok



Just steps away from Terminal 21,
EmQuartier, Emsphere & Emporium



Connected by BTS Asok Station
& MRT Sukhumvit Station

Tripadvisor Travelers' Choice Awards

Tripadvisor
Travellers'
Choice Awards



Thanks for your support!



Location

Shopping Malls

Terminal 21: 9-minute walk
Emsphere, EmQuartier, and Emporium: 7-12 minute walk

Transportation

BTS (Asok Station): 8-minute walk
MRT (Sukhumvit Station): 8-minute walk

Convention Centers

QSNCC: Free hotel shuttle or just 1 MRT station away
BITEC: 9 BTS stations away

Parks

Benchakitti Park: 1 minute from QSNCC Station
Benchasiri Park: 1 minute from Phrom Phong Station

Airports

Suvarnabhumi Airport:
Public Transport: MRT to Makkasan Station, then transfer to the Airport Rail Link
Taxi: 30-40 minutes, depending on traffic
Don Mueang Airport:
Public Transport: MRT to Don Mueang Station
Taxi: 30-50 minutes, depending on traffic

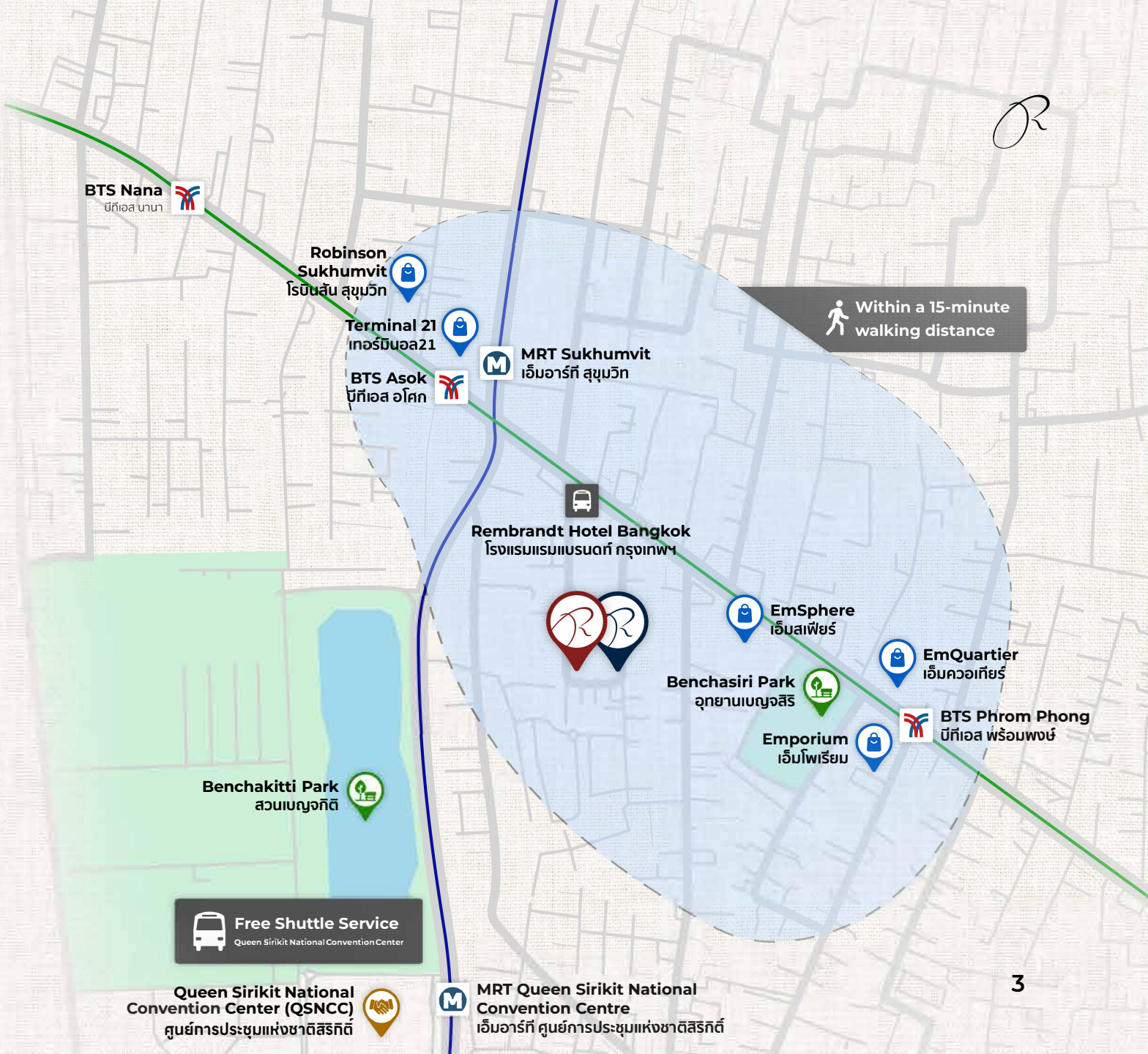







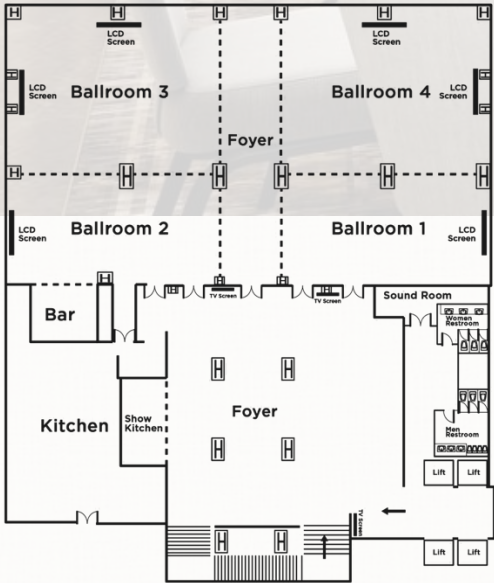

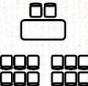
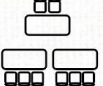
GRAND BALLROOM

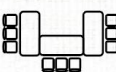
Located: 2nd Floor

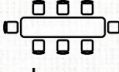

Venue	<div><div>m²</div><div>Area (sq.m)</div></div>	<div><div>ft²</div><div>Area (sq.ft)</div></div>	<div><div>↔</div><div>Size (mxm)</div></div>	<div><div>↑↓</div><div>Ceiling (m)</div></div>	<div><div></div><div>Theatre</div></div>	<div><div></div><div>Classroom</div></div>	<div><div></div><div>Cabaret</div></div>	<div><div></div><div>U-Shape</div></div>	<div><div></div><div>Banquet</div></div>	<div><div></div><div>Long Table</div></div>	<div><div></div><div>Cocktail</div></div>
Foyer	280	3,014	16x17.5	3.2-3.95	-	-	-	-	-	-	250
Grand Ballroom	745	8,019	36.5 x 20.4	3.2-3.95	800-1,000	400	360	300-350	400-440	180-200	800-1,000
Ballroom 1/2	110	1,087	16.1x6.3	3.2-3.95	60-80	50-60	40-50	36-40	60-80	32	60-100
Ballroom 3/4	227	2,443	16.1x14.1	3.2-3.95	125	100	60-80	60-80	100	60-80	100-150
Ballroom 1+4/2+3	337	3,531	16.1x20.4	3.2-3.95	200-220	180-200	80-120	80-100	160-180	80-120	200-250









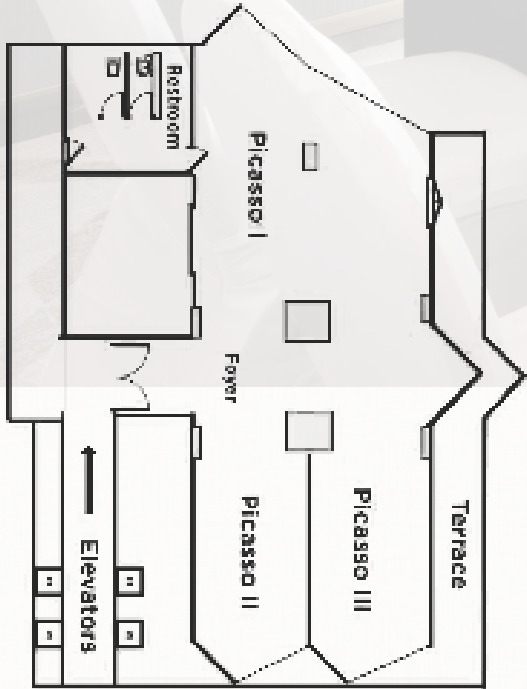

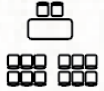
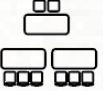
PICASSO I-II-III

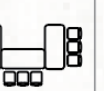
Located: 23rd Floor

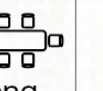

Venue	<div>m²</div> <div>Area (sq.m)</div>	<div>ft²</div> <div>Area (sq.ft)</div>	<div>↔</div> <div>Size (mxm)</div>	<div>↕</div> <div>Ceiling (m)</div>	<div></div> <div>Theatre</div>	<div></div> <div>Classroom</div>	<div></div> <div>Cabaret</div>	<div></div> <div>U-Shape</div>	<div></div> <div>Banquet</div>	<div></div> <div>Long Table</div>	<div></div> <div>Cocktail</div>
Foyer	32	345	4x8	2.2-2.6	-	-	-	-	-	-	-
Picasso	225	2,422	20.6x8	2.2-2.6	120	60	-	-	80	-	140
Picasso I	66	710	8.3x8	2.2-2.6	60	40	30	30	40	30	60
Picasso 2/3	33	355	8.3x4	2.2-2.6	30	12	8-16	15	16	20	20-30
Terrace	92	990	16x3.9	-	-	-	-	-	-	-	80



MICHELANGELO

Located: 25th Floor



Venue	<div><div>m²</div><div>Area (sq.m)</div></div>	<div><div>ft²</div><div>Area (sq.ft)</div></div>	<div><div>↔</div><div>Size (mxm)</div></div>	<div><div>↑↓</div><div>Ceiling (m)</div></div>	<div><div>👤</div><div>Theatre</div></div>	<div><div>👤</div><div>Classroom</div></div>	<div><div>👤</div><div>Cabaret</div></div>	<div><div>👤</div><div>U-Shape</div></div>	<div><div>👤</div><div>Banquet</div></div>	<div><div>👤</div><div>Long Table</div></div>	<div><div>👤</div><div>Cocktail</div></div>
Michelangelo	146.4	1,576	8x18.3	2.2-2.6	150	100	50	45	80	60	150

MICHELANGELO





GLASS HOUSE - POOLSIDE

Located: 11th Floor

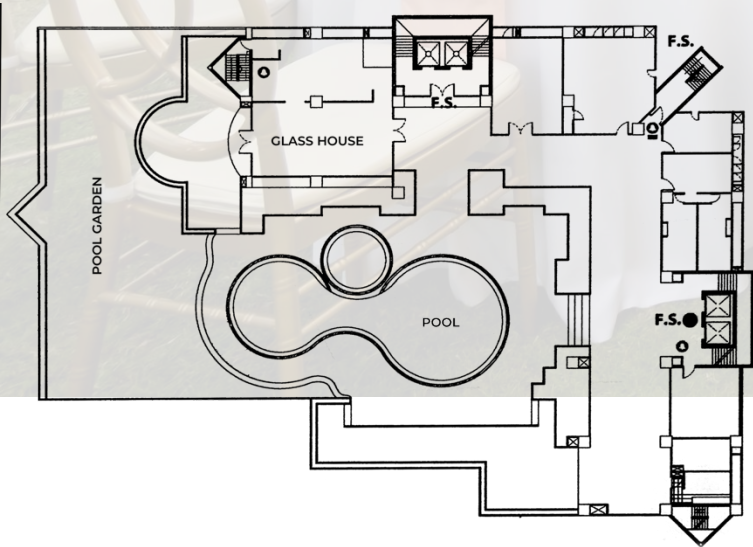

Venue	<div>m²</div> <div>Area (sq.m)</div>	<div>ft²</div> <div>Area (sq.ft)</div>	<div>↔</div> <div>Size (mxm)</div>	<div>↕</div> <div>Ceiling (m)</div>	<div>Icon: Theatre</div> <div>Theatre</div>	<div>Icon: Classroom</div> <div>Classroom</div>	<div>Icon: Cabaret</div> <div>Cabaret</div>	<div>Icon: U-Shape</div> <div>U-Shape</div>	<div>Icon: Banquet</div> <div>Banquet</div>	<div>Icon: Long Table</div> <div>Long Table</div>	<div>Icon: Cocktail</div> <div>Cocktail</div>
Pool Side	-	-	-	-	-	-	-	-	150-170	-	200-250
Glass House	34.5	371	10x4	3	60	30	30	25-30	30-40	30	60-80

GLASS HOUSE - POOLSIDE





REMBRANDT ROOM 1

Located: M Floor

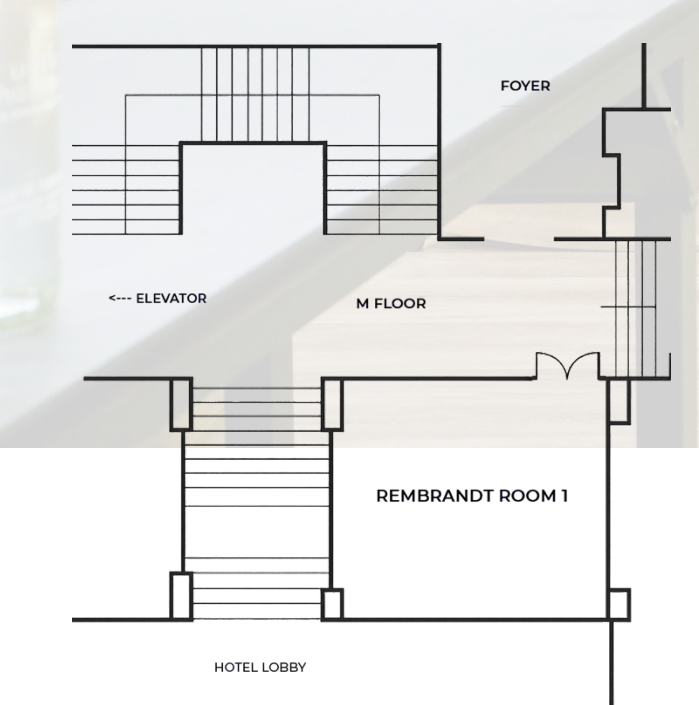

Capacity

Venue	<div><div>m²</div><div>Area (sq.m)</div></div>	<div><div>ft²</div><div>Area (sq.ft)</div></div>	<div><div>↔</div><div>Size (mxm)</div></div>	<div><div>↕</div><div>Ceiling (m)</div></div>	<div><div>🎤</div><div>Theatre</div></div>	<div><div>📚</div><div>Classroom</div></div>	<div><div>🍸</div><div>Cabaret</div></div>	<div><div>🚪</div><div>U-Shape</div></div>	<div><div>🍽️</div><div>Banquet</div></div>	<div><div>🍷</div><div>Long Table</div></div>	<div><div>🍹</div><div>Cocktail</div></div>
Rembrandt 1	64	688.89	8x5.25	2.2-2.6	60	30	30	20	40	30	70

REMBRANDT ROOM 1





Private Red Pepper

Located: 01st Floor

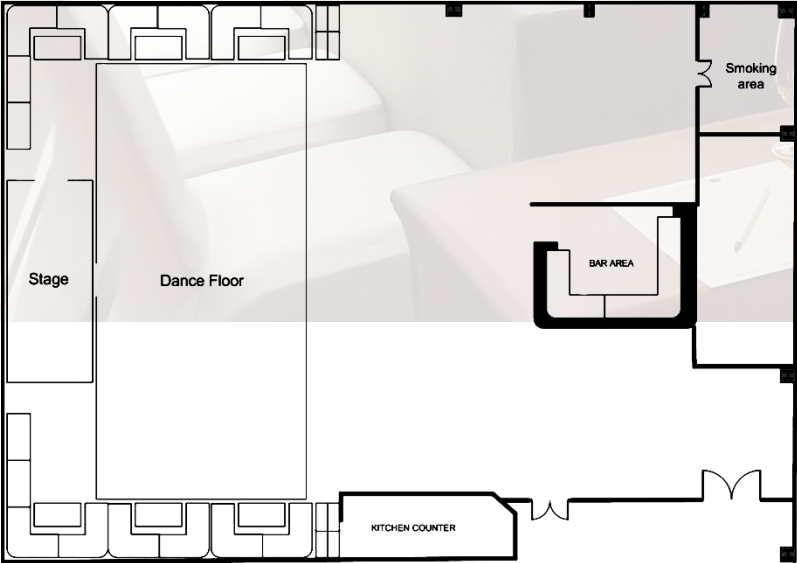

Venue	<div>m²</div> Area (sq.m)	<div>ft²</div> Area (sq.ft)	<div>↔</div> Size (m x m)	<div>↑↓</div> Ceiling (m)	<div>🛋️</div> Theatre	<div>🛋️</div> Classroom	<div>🍷</div> Cabaret	<div>🛋️</div> U-Shape	<div>🍷</div> Banquet	<div>🛋️</div> Long Table	<div>🍷</div> Cocktail
Red Pepper	195	2,099	10x19.5	4	80-90	60-80	60-70	40-50	80-100	40-50	60-80

Private Red Pepper



COFFEE BREAK



A romantic scene of a bride and groom walking down a wide, ornate staircase. The groom, on the left, is wearing a light brown suit and is looking down at the bride's hand. The bride, on the right, is wearing a long, flowing white wedding dress with a full skirt and long gloves. She is looking up at the groom. The staircase has a wooden railing and a patterned carpet. The background shows the upper levels of the hotel with a modern, geometric design.

Rembrandt
HOTEL BANGKOK

Make your dream *Wedding*
with Rembrandt Hotel Bangkok

Make Your Special day Unforgettable

From traditional floral trays and elegant decorations to exquisite menus and luxurious accommodations, our expert team will work with you to create the wedding of your dreams.

R

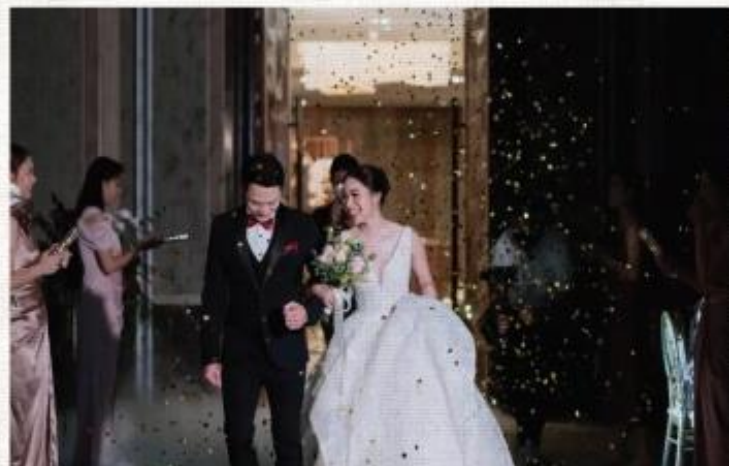

Thai Wedding

- Monk Ceremony
- Decorative Wedding Cake
- Wedding Garland
- Bridal bouquet
- Honeymoon Suite
- Flower Archway



Engagement

- Monk Ceremony
- Thai Pouring Ceremony
- Chinese Tea Ceremony
- Engagement Ceremony
- Flowers
- Function Space



Indian Wedding

- Ice Carving
- Mandap Setup
- Flower Pillars
- Bride & Groom Jaimala
- Honeymoon Suite
- Floral Archway

Standard Set up

by our Hotel Wedding Specialists

R



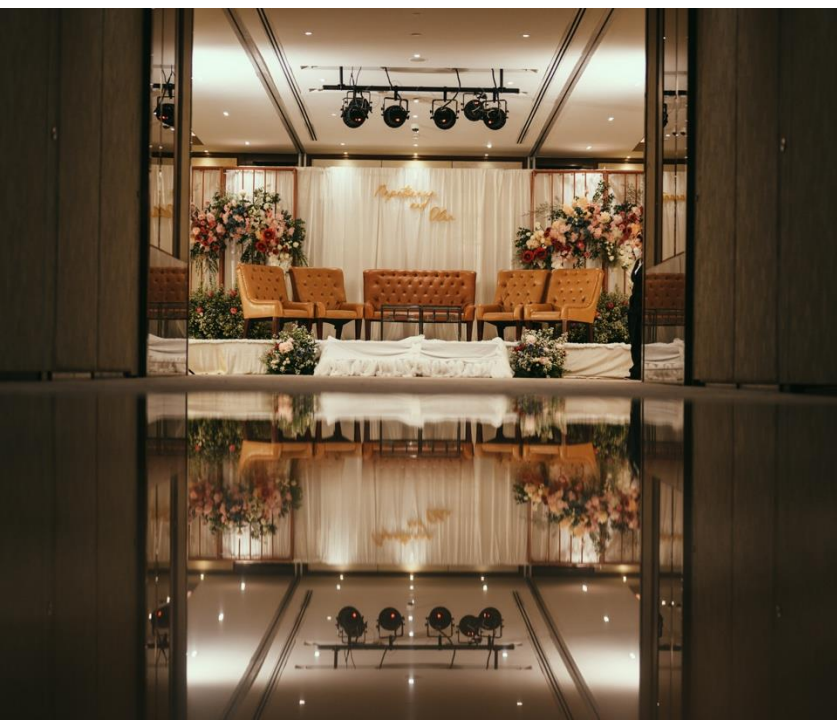

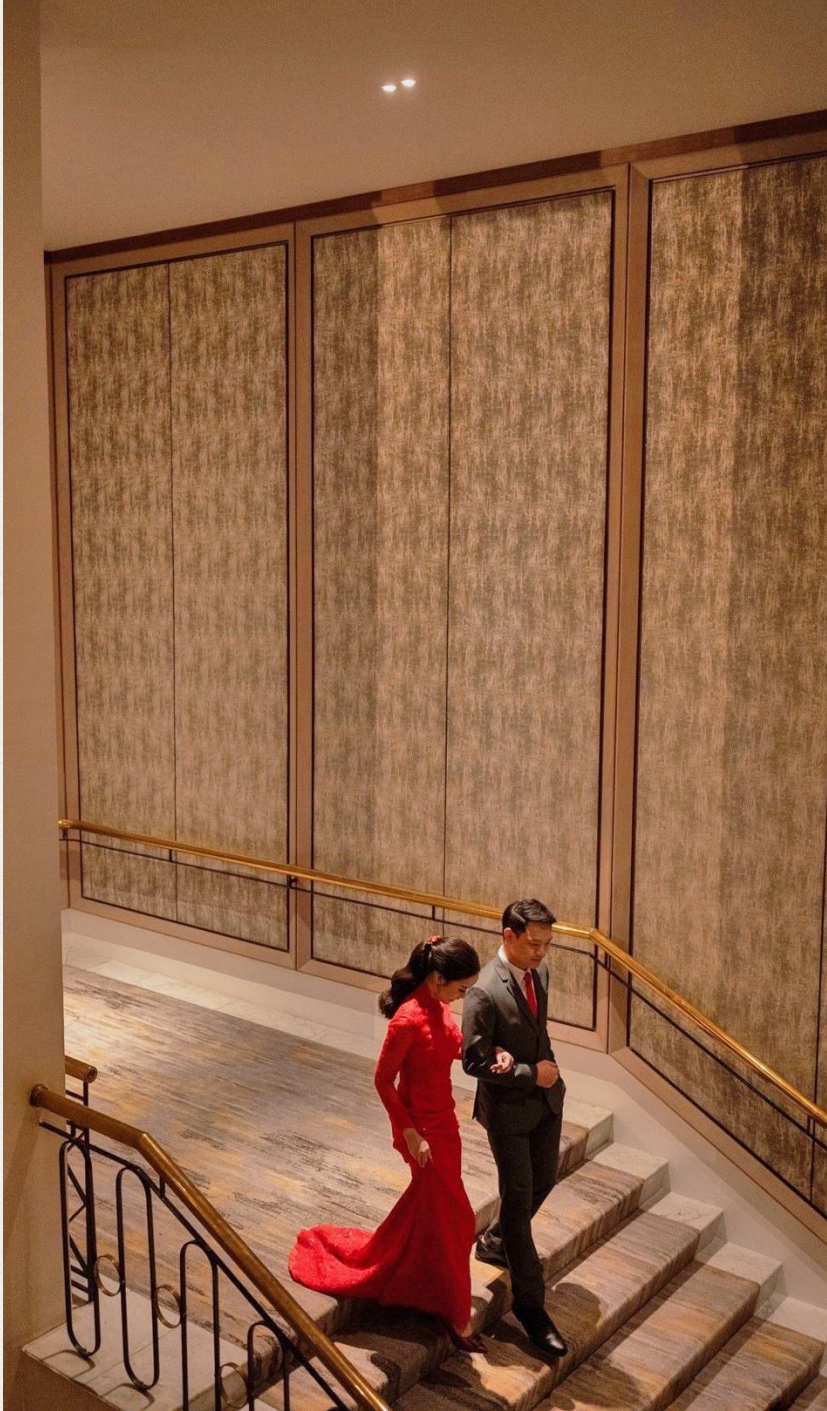

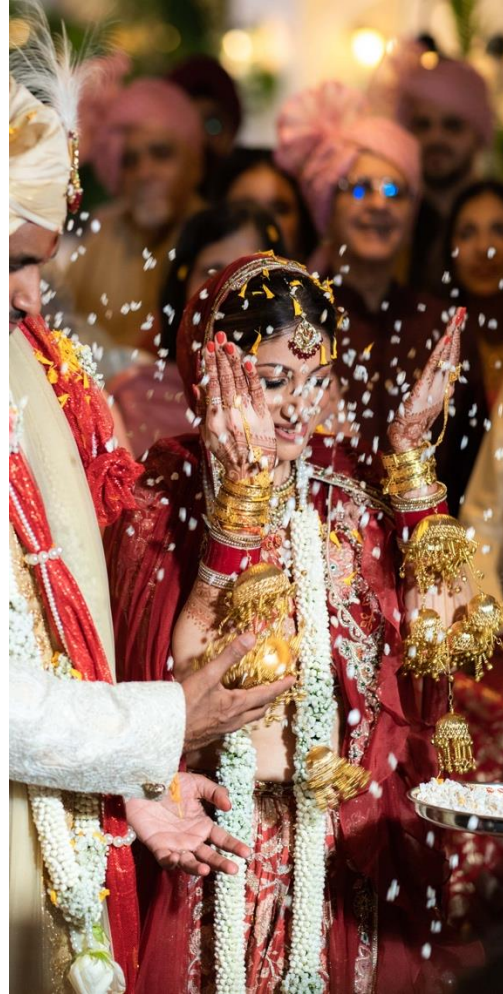

Red Pepper

Buffet Breakfast: **06:00 - 10:30 hrs.**

A La Carte: **11:00 - 22:30 hrs.**

Room Service: **24 hrs.**

Red Pepper is an all-day dining destination, offering a vibrant mix of Thai, Indian, Asian, and international flavors. Start your morning with a delicious breakfast from 06:00 - 10:30 hrs, then continue your culinary journey with our à la carte menu, available until late at night. Whether you're craving local favorites or global delights, Red Pepper has something to satisfy every palate.



MEXICANO

RESTAURANTE AUTÉNTICO

Available Daily: **12:00 – 23:00 hrs**

Mexicano Restaurante Autentico brings the vibrant, lively flavors and spices of Mexico right to Sukhumvit, making it the ultimate spot for a true Mexican fiesta! Don't miss out on our special promotions, adding even more flavor and excitement to your dining experience!



R

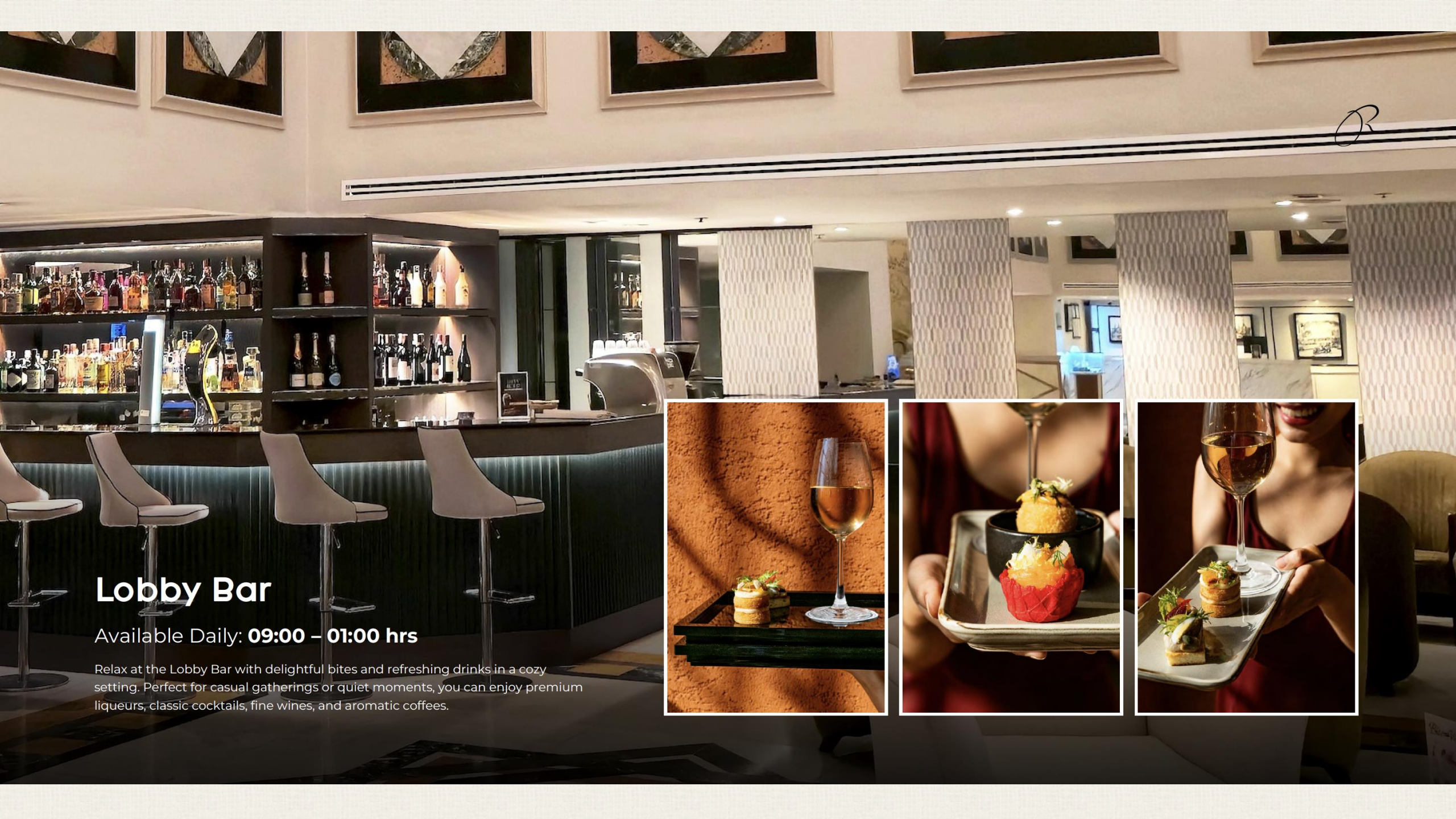

R

Lobby Bar

Available Daily: **09:00 – 01:00 hrs**

Relax at the Lobby Bar with delightful bites and refreshing drinks in a cozy setting. Perfect for casual gatherings or quiet moments, you can enjoy premium liqueurs, classic cocktails, fine wines, and aromatic coffees.



In-Room Dining

Experience 24-hour in-room dining, designed for your comfort



BREAKFAST MENU

Available Daily **07:00 - 11:00 hrs**



ALL DAY DINING

Available Daily **11:00 - 23:00 hrs**



LATE HOURS DINING

Available Daily **23:00 - 07:00 hrs**



R

Free Shuttle Service



Main Road Sukhumvit 18 or Skhumvit 20

Rembrandt Hotel Bangkok offer a complimentary shuttle to Sukhumvit 18 or 20, providing easy access to the BTS, MRT, and Bangkok's top shopping malls.



3 min.



5 min.



8 min.



7 min.



10 min.



12 min.



Queen Sirikit National Convention Center

Rembrandt Hotel Bangkok provide a complimentary shuttle service to Queen Sirikit National Convention Center (QSNCC) during events, ensuring a seamless and hassle-free journey for guests.





Shuttle Schedule

Trip No.	Departure Time
1	8:00 hrs.
2	8:30 hrs.
3	9:00 hrs.
4	9:30 hrs.
5	10:00 hrs.
6	10:30 hrs.
7	11:00 hrs.
8	11:30 hrs.
9	12:00 hrs.
10	12:30 hrs.
11	13:00 hrs.
12	13:30 hrs.
13	14:00 hrs.
14	14:30 hrs.
15	15:00 hrs.
16	15:30 hrs.
17	16:00 hrs.
18	16:30 hrs.
Rush Hours : 17:00 - 19:30 hrs.	
19	19:30 hrs.
20	20:00 hrs.



Shuttle Service
Available 8:00 - 20:00 hrs

*Service may be delayed during rush hour.
*Out-of-schedule service available upon request



Every 30 Minutes



Drop off point (main road)
Sukhumvit 18 & Sukhumvit 20



Route Operation Simulation

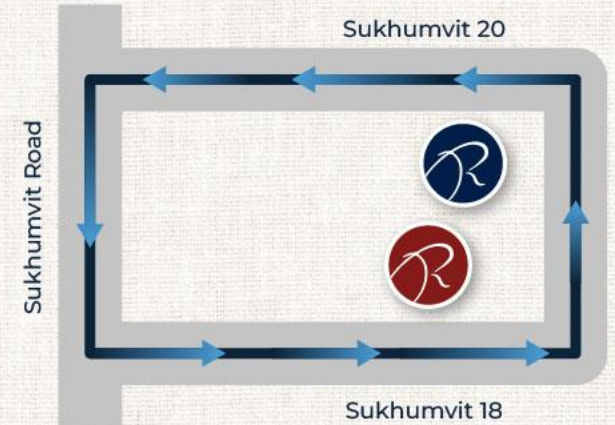



Free Shuttle Service

QUEEN SIRIKIT NATIONAL CONVENTION CENTER

Hotel



QSNCC

For inquiries, please reach out to our concierge team.

08:00

09:00

10:00

11:00

Waiting point at QSNCC
Between gate 3 - 4

15:00

16:00

17:00

18:00

QSNCC



Rembrandt
HOTEL BANGKOK



Rembrandt
RESIDENCES BANGKOK

THANK YOU FOR YOUR TIME
we look forward to seeing you soon.



Managed by Rembrandt Asset Management